

Martin Miller

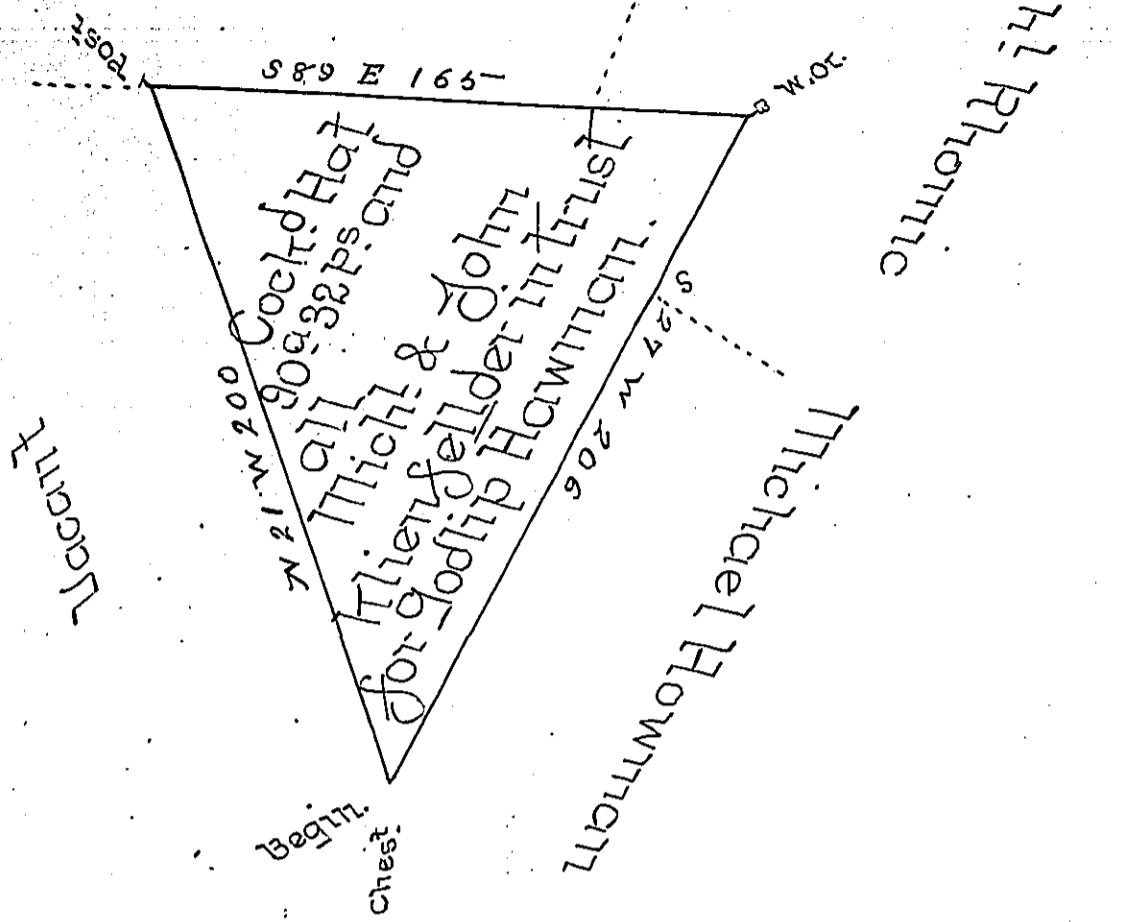

A Draught of a Tract of Land situate in Shrewsbury Township York County Surveyed the 24<sup>th</sup> of the 30<sup>th</sup> month 1768 in Pursuance of an Application Granted to Michael and John Klienfelder in Trust for Godlip Howman No 4501 for \_\_\_\_\_ Dated October the 16<sup>th</sup> 1767 unimproved

P W<sup>m</sup> Matthews D<sup>y</sup> S<sup>e</sup>

To J<sup>no</sup> Lukens Esq<sup>r</sup> }  
Survey Gen<sup>l</sup>

IN TESTIMONY that the above is a copy of the original remaining on file in the Department of Internal Affairs of Pennsylvania, made conformably to an Act of Assembly approved the 16th day of February, 1833, I have hereunto set my Hand and caused the Seal of said Department to be affixed at Harrisburg, this Third day of January 1899.

*James W. Latta*  
Secretary of Internal Affairs.